

Nursery and Reception

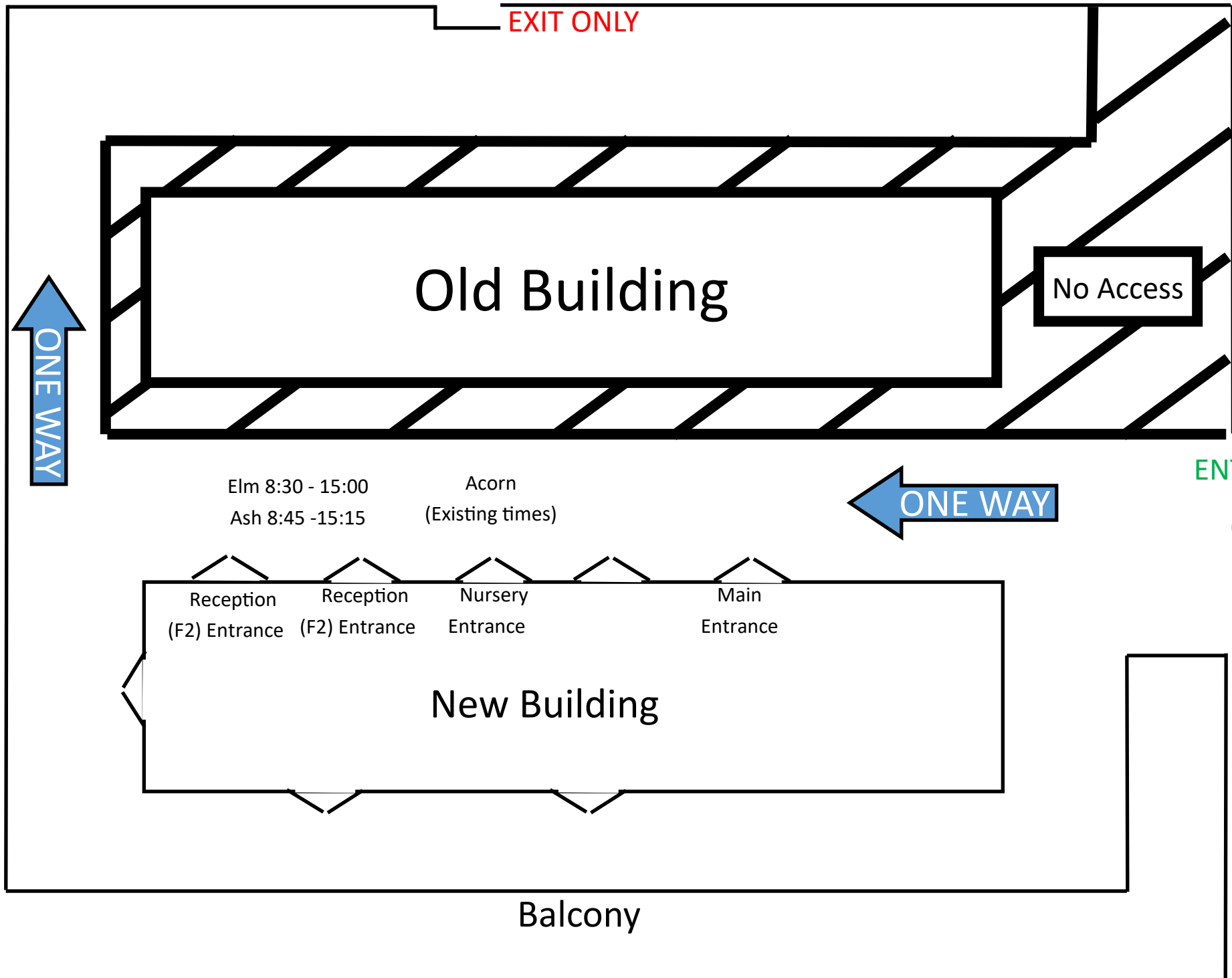

EXIT ONLY

Old Building

No Access

ONE WAY

Elm 8:30 - 15:00

Ash 8:45 - 15:15

Acorn
(Existing times)

ONE WAY

ENTRANCE
ONLY

Reception
(F2) Entrance

Reception
(F2) Entrance

Nursery
Entrance

Main
Entrance

New Building

Balcony

Year 1

Start of day: 8:30

End of day: 15:00

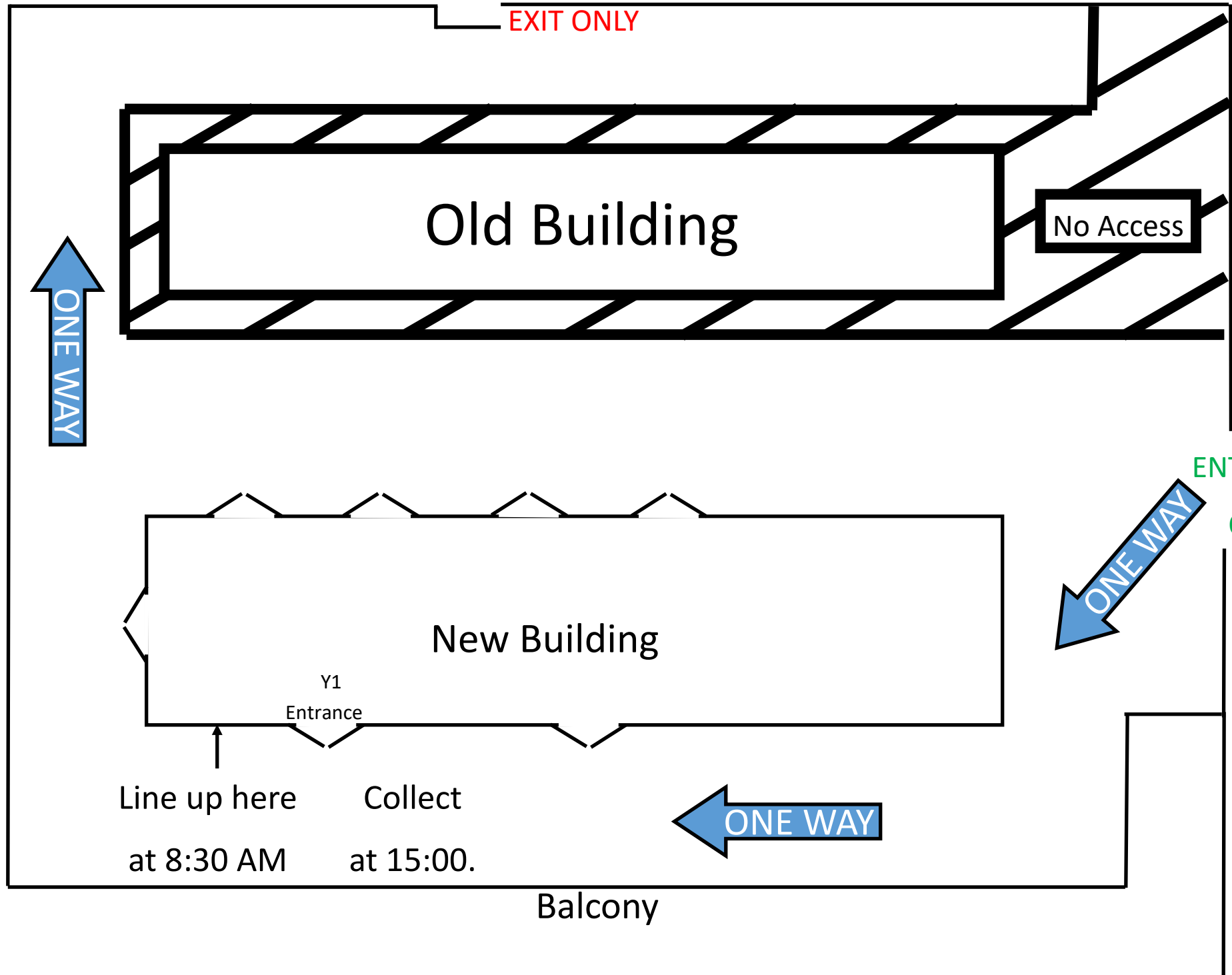

Year 2

Start of day: 8:45

End of day: 15:15

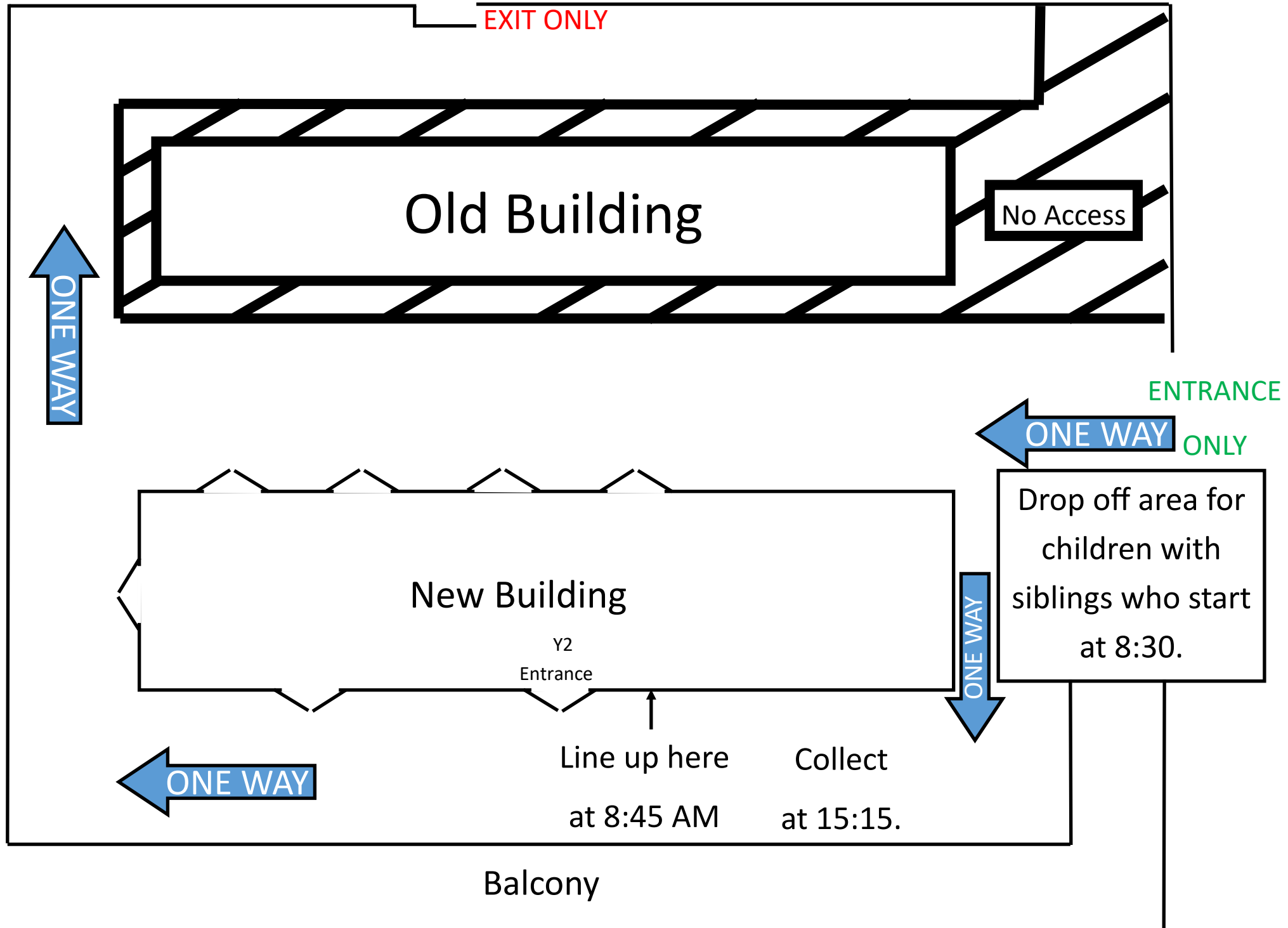

Year 3

Start of day: 8:45

End of day: 15:15

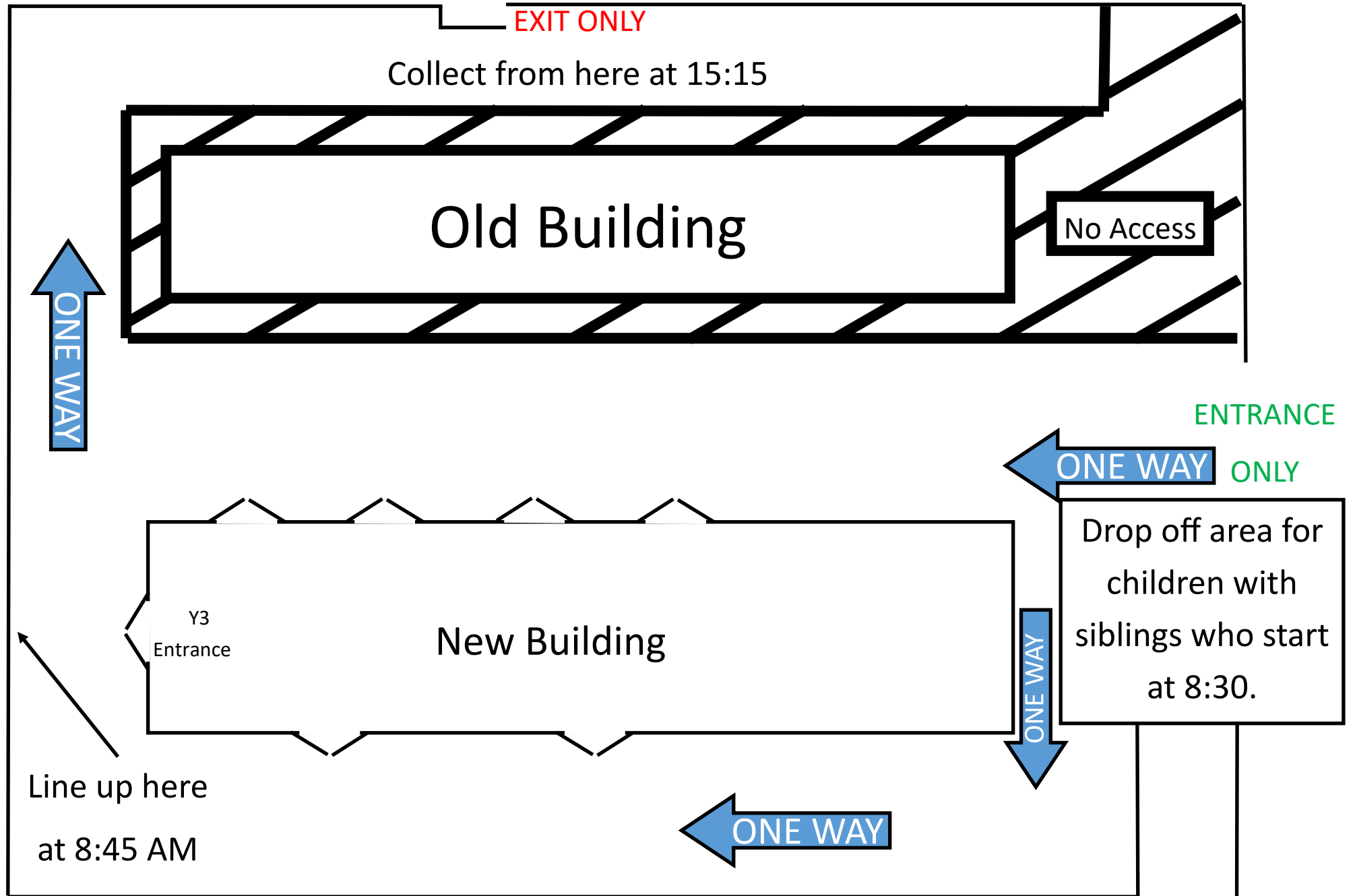

EXIT ONLY

Collect from here at 15:15

Old Building

No Access

ONE WAY

ENTRANCE

ONE WAY ONLY

Drop off area for children with siblings who start at 8:30.

Y3 Entrance

New Building

ONE WAY

Line up here at 8:45 AM

ONE WAY

Balcony

Year 4

Start of day: 8:30

End of day: 15:00

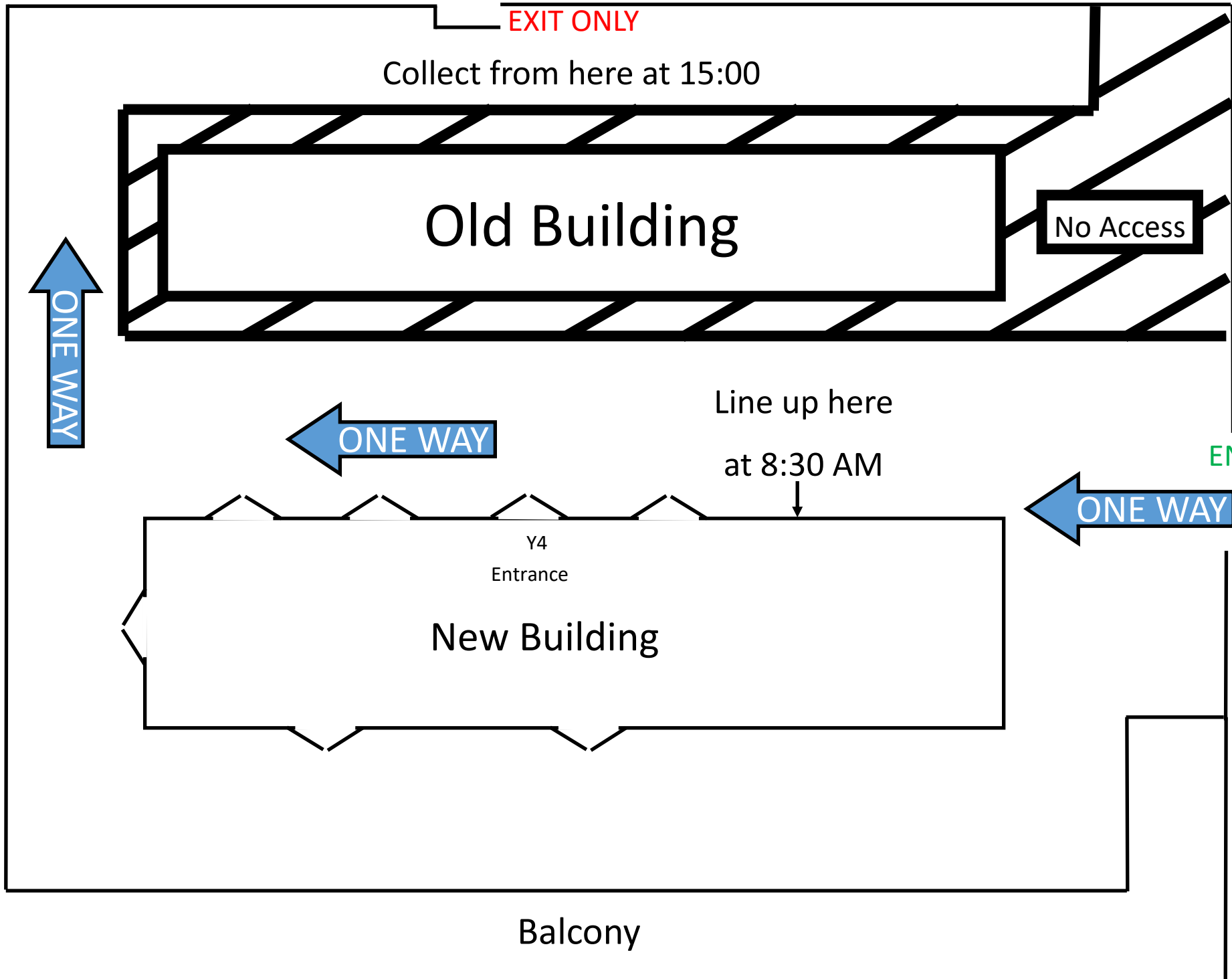

Year 5

Start of day: 8:30

End of day: 15:00

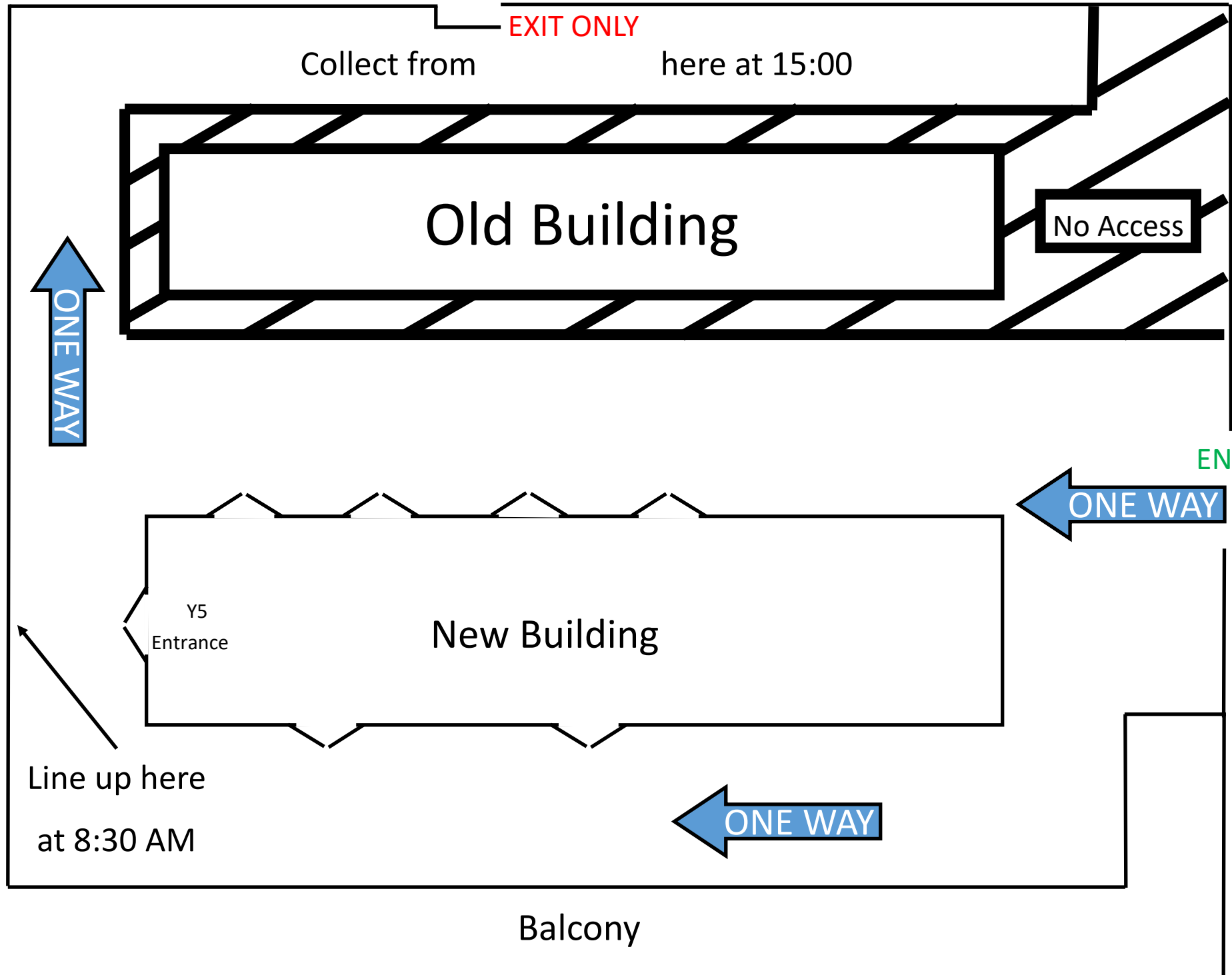

EXIT ONLY

Collect from

here at 15:00

Old Building

No Access

ONE WAY

ENTRANCE

ONE WAY

ONLY

Y5
Entrance

New Building

Line up here
at 8:30 AM

ONE WAY

Balcony

Year 6

Start of day: 8:45

End of day: 15:15

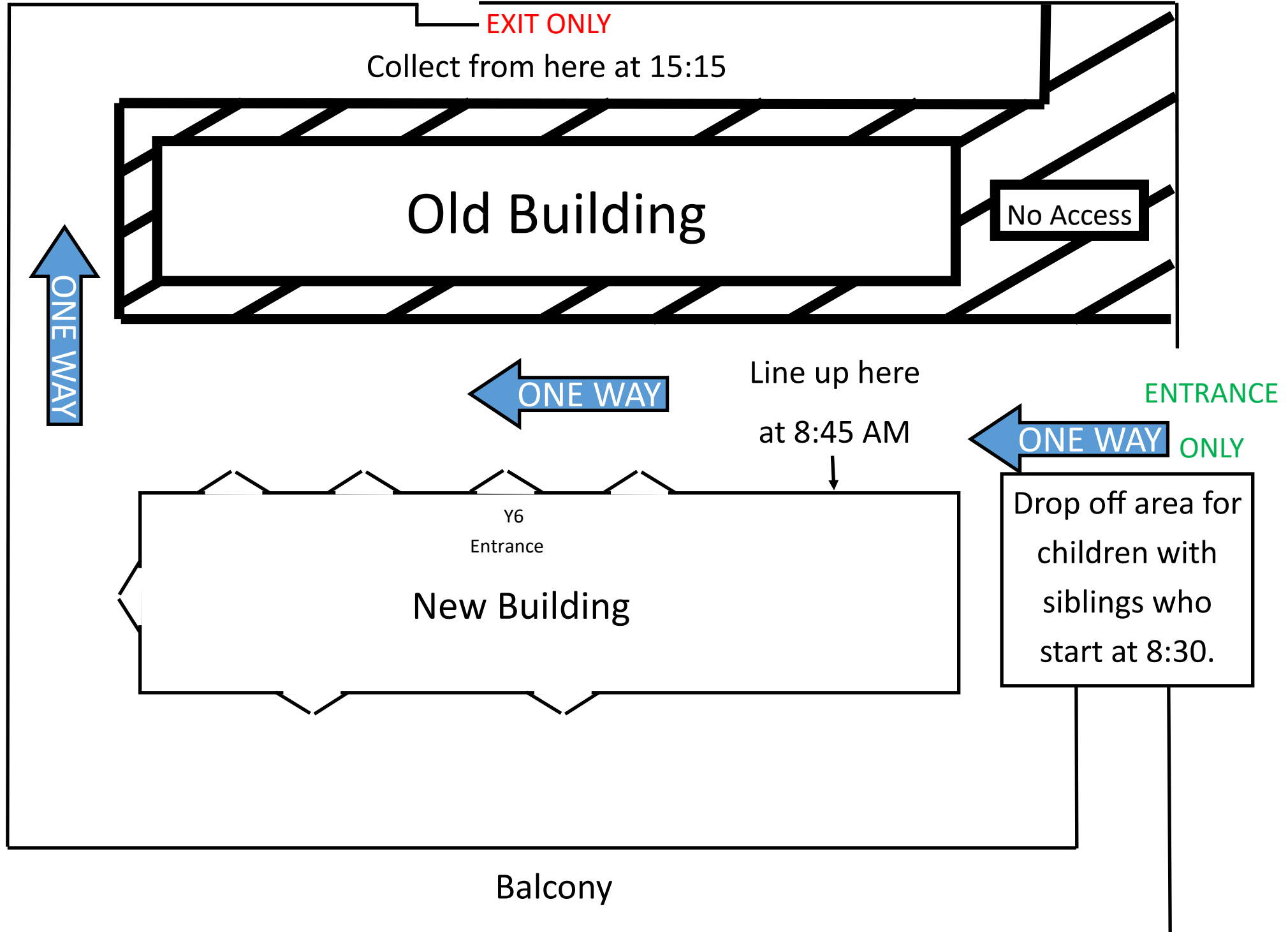

Return to school instructions

- School reopens on Thursday 5th November.
- Check the start time for your year group on the other side of this page.
CHECK CAREFULLY AS SOME YEAR GROUPS HAVE HAD TO CHANGE.
- Children who start at 8:45 but have siblings who start at 8:30 can wait in the early collection area by the entrance gate.
- The one way system and exit and entrance gates have changed. Please check your entrance gate on the other side of this page and follow signage around school.
- The time shown on the map is the time that doors will close. Children who are late will have to wait outside, whatever the weather, so that bubbles do not mix.
- Staff will be on hand to direct. Please follow instructions so that we can keep all members of the school community safe.