

Nursery and Reception

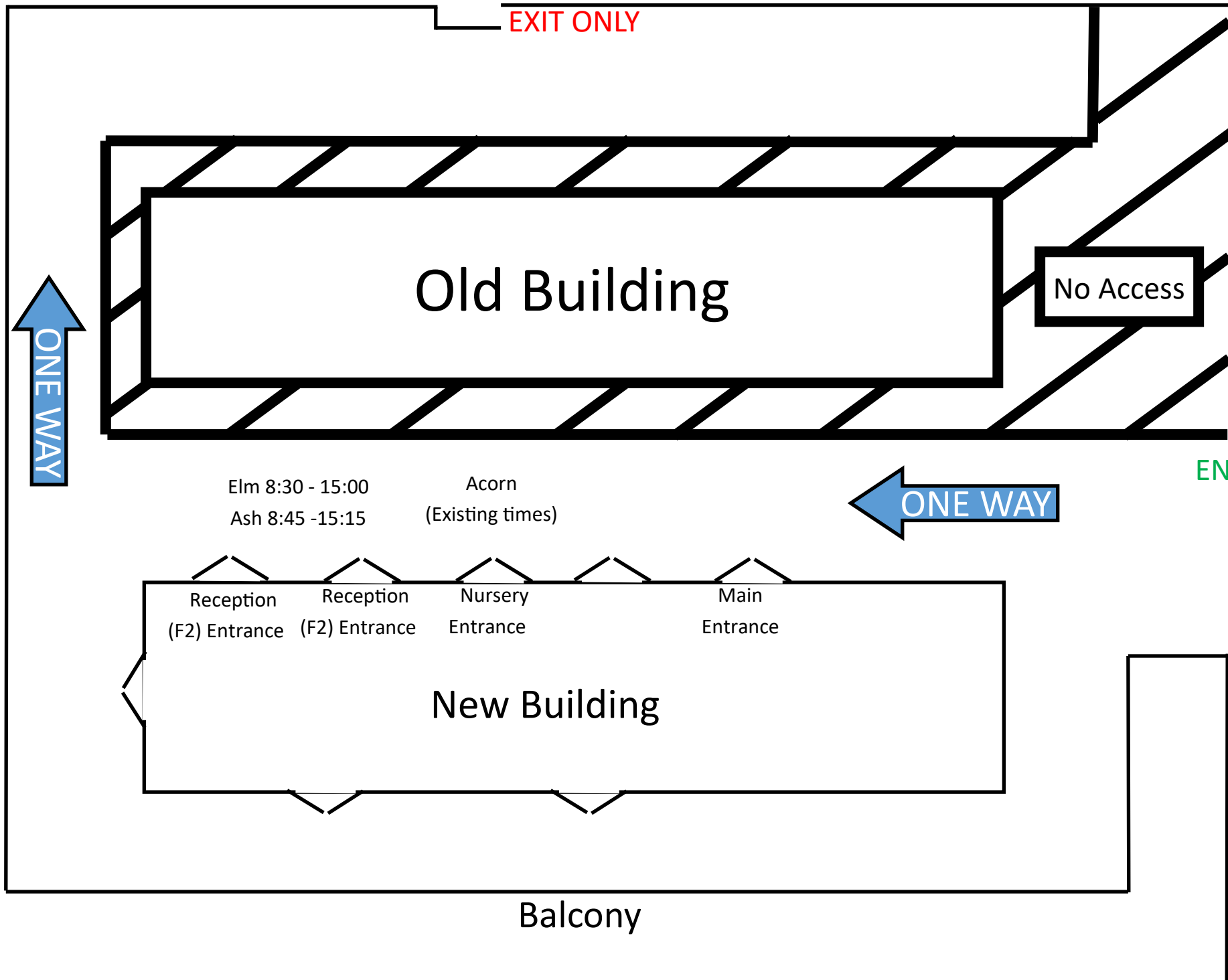

Elm 8:30 - 15:00
Ash 8:45 - 15:15

Acorn
(Existing times)

Reception
(F2) Entrance

Reception
(F2) Entrance

Nursery
Entrance

Main
Entrance

New Building

Balcony

Return to school instructions

- School reopens on Thursday 5th November.
- Check the start time for your year group on the other side of this page.
CHECK CAREFULLY AS SOME YEAR GROUPS HAVE HAD TO CHANGE.
- Children who start at 8:45 but have siblings who start at 8:30 can wait in the early collection area by the entrance gate.
- The one way system and exit and entrance gates have changed. Please check your entrance gate on the other side of this page and follow signage around school.
- The time shown on the map is the time that doors will close. Children who are late will have to wait outside, whatever the weather, so that bubbles do not mix.
- Staff will be on hand to direct. Please follow instructions so that we can keep all members of the school community safe.